



**PIGNI PER BUSSOLA CONICA TEMPERATI AD INDUZIONE - DIN 8187 - ISO 606**  
**SPROCKETS FOR TAPER BUSHES WITH HARDENED TEETH - DIN 8187 - ISO 606**

**3/8" x 7/32"**  
**9,525 x 5,72 mm**  
**Rullo 6,35 mm**  
**06B - 1**

B1	C	r3
5,3	1	10

Materiale: Acciaio C45

Z	de	dp	codice	semplici			
				dm	A	bussola	Kg.
17	55,5	51,83	391330017	45	22	1008	0,11
19	61,6	57,86	391330019	45	22	1008	0,15
21	67,6	63,90	391330021	46	22	1008	0,18
23	73,7	69,95	391330023	63	25	1210	0,27
25	79,7	75,99	391330025	63	25	1210	0,32

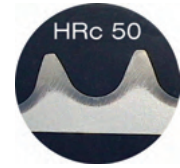
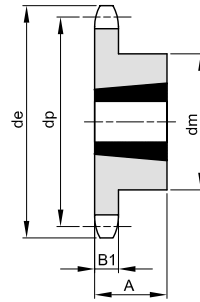
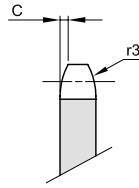

**1/2" x 5/16"**  
**12,7 x 7,75 mm**  
**Rullo 8,51 mm**  
**08B - 1**

B1	C	r3
7,2	1,3	13

Materiale: Acciaio C45

Z	de	dp	codice	semplici			
				dm	A	bussola	Kg.
15	65,9	61,09	391340015	45	22	1008	0,16
17	74,0	69,11	391340017	60	25	1210	0,22
19	82,0	77,16	391340019	63	25	1210	0,33
21	90,1	85,22	391340021	71	25	1610	0,36
23	98,9	93,27	391340023	76	25	1610	0,50

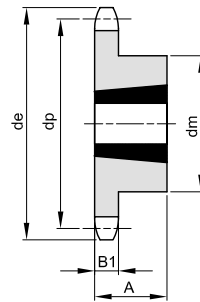
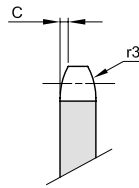

**5/8" x 3/8"**  
**15,875 x 9,65 mm**  
**Rullo 10,16 mm**  
**10B - 1**

B1	C	r3
9,1	1,6	16

Materiale: Acciaio C45

Z	de	dp	codice	semplici			
				dm	A	bussola	Kg.
13	73,2	66,33	391350013	47	22	1008	0,23
15	83,2	76,35	391350015	60	25	1210	0,30
17	93,3	86,39	391350017	71	25	1610	0,38
19	103,3	96,44	391350019	75	25	1610	0,54
21	113,4	106,51	391350021	76	25	1610	0,65

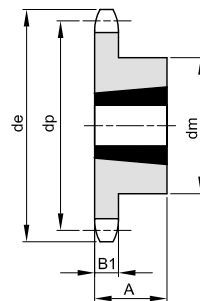
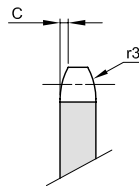

Z	de	dp	codice	semplici			
				dm	A	bussola	Kg.
27	85,7	82,04	391330027	63	25	1210	0,34
30	94,8	91,12	391330030	63	25	1210	0,39

Z	de	dp	codice	semplici			
				dm	A	bussola	Kg.
25	106,7	101,32	391340025	76	25	1610	0,56
27	114,8	109,39	391340027	76	25	1610	0,63
30	126,9	121,49	391340030	90	32	2012	0,91

Z	de	dp	codice	semplici			
				dm	A	bussola	Kg.
23	123,5	116,58	391350023	76	25	1610	0,77
25	133,6	126,66	391350025	90	32	2012	1,05
27	143,6	136,74	391350027	90	32	2012	1,17
30	158,8	151,87	391350030	90	32	2012	1,40



**PIGNONI PER BUSSOLA CONICA TEMPERATI AD INDUZIONE - DIN 8187 - ISO 606**  
**SPROCKETS FOR TAPER BUSHES WITH HARDENED TEETH - DIN 8187 - ISO 606**

**3/4" x 7/16"**  
**19,05 x 11,68 mm**  
 Rullo 12,07 mm  
**12B - 1**

B1	C	r3
11,1	2	19

Materiale: Acciaio C45

Z	de	dp	codice	semplici			
				dm	A	bussola	Kg.
13	87,8	79,60	391360013	60	25	1210	0,35
15	99,8	91,62	391360015	70	25	1610	0,44
17	111,9	103,67	391360017	76	25	1610	0,66
19	123,9	115,73	391360019	90	32	2012	0,94
21	136,0	127,81	391360021	102	44	2517	1,24

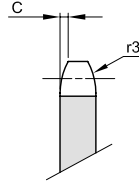
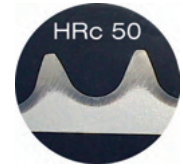
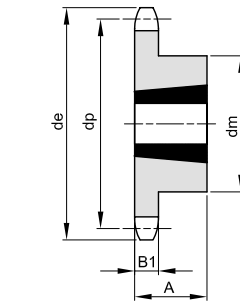

**1" x 17,02 mm**  
**25,4 x 17,02 mm**  
 Rullo 15,88 mm  
**16B - 1**

B1	C	r3
16,2	2,5	26

Materiale: Acciaio C45

Z	de	dp	codice	semplici			
				dm	A	bussola	Kg.
15	133,7	122,16	391380015	76	38	1615	1,30
17	149,8	138,23	391380017	90	32	2012	1,59
19	165,9	154,31	391380019	108	44	2517	2,29
21	182,0	170,42	391380021	110	44	2517	2,81
23	198,1	186,53	391380023	110	44	2517	3,38

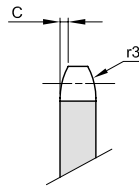
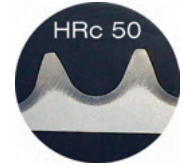
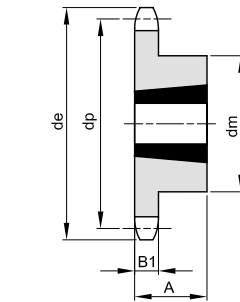

**1"1/4 x 3/4"**  
**31,75 x 19,56 mm**  
 Rullo 19,05 mm  
**20B - 1**

B1	C	r3
18,5	3,5	32

Materiale: Acciaio C45

Z	de	dp	codice	semplici			
				dm	A	bussola	Kg.
15	167,7	152,72	391400015	110	44	2517	3,39
17	187,7	172,78	391400017	110	44	2517	5,07
19	207,9	192,91	391400019	110	44	2517	6,75
21	228,0	213,04	391400021	120	44	2517	7,70
23	248,2	233,17	391400023	120	44	2517	8,78

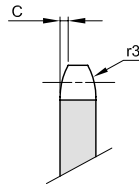
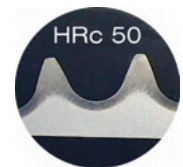
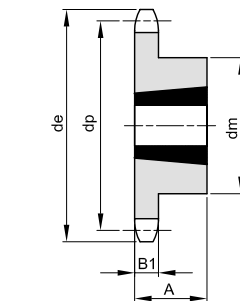

Z	de	dp	codice	semplici			
				dm	A	bussola	Kg.
25	268,4	253,33	391400025	120	44	2517	9,50