

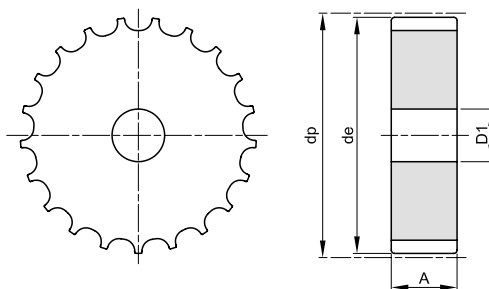

RUOTE PER CATENE A CERNIERA - DIN 8153 WHEELS FOR TABLE TOP CHAINS - DIN 8153



Materiale: Acciaio C45

Z	codice	passo	de	dp	D1	A	Kg.
15	351420015	1"1/2 (38,1)	92,0	93,67	16	43,5	1,86
17	351420017	1"1/2 (38,1)	104,7	105,47	16	43,5	2,34
19	351420019	1"1/2 (38,1)	116,6	117,34	16	43,5	3,10
21	351420021	1"1/2 (38,1)	129,7	129,26	20	43,5	3,79
23	351420023	1"1/2 (38,1)	141,6	141,22	20	43,5	4,46
25	351420025	1"1/2 (38,1)	153,6	153,20	20	43,5	5,50
27	351420027	1"1/2 (38,1)	165,6	165,21	20	43,5	6,31
29	351420029	1"1/2 (38,1)	177,7	177,23	20	43,5	7,31
31	351420031	1"1/2 (38,1)	189,7	189,27	20	43,5	8,63